

**HIGHWAY HAWK**  
*passion for chrome*

Taillight with integrated turnsignals

**Yamaha XVS 950A**

Art.no. 682-100

Note: removing OEM (rear) turnsignals or change to LED, requires use of replacement Highway Hawk relay 68-2525

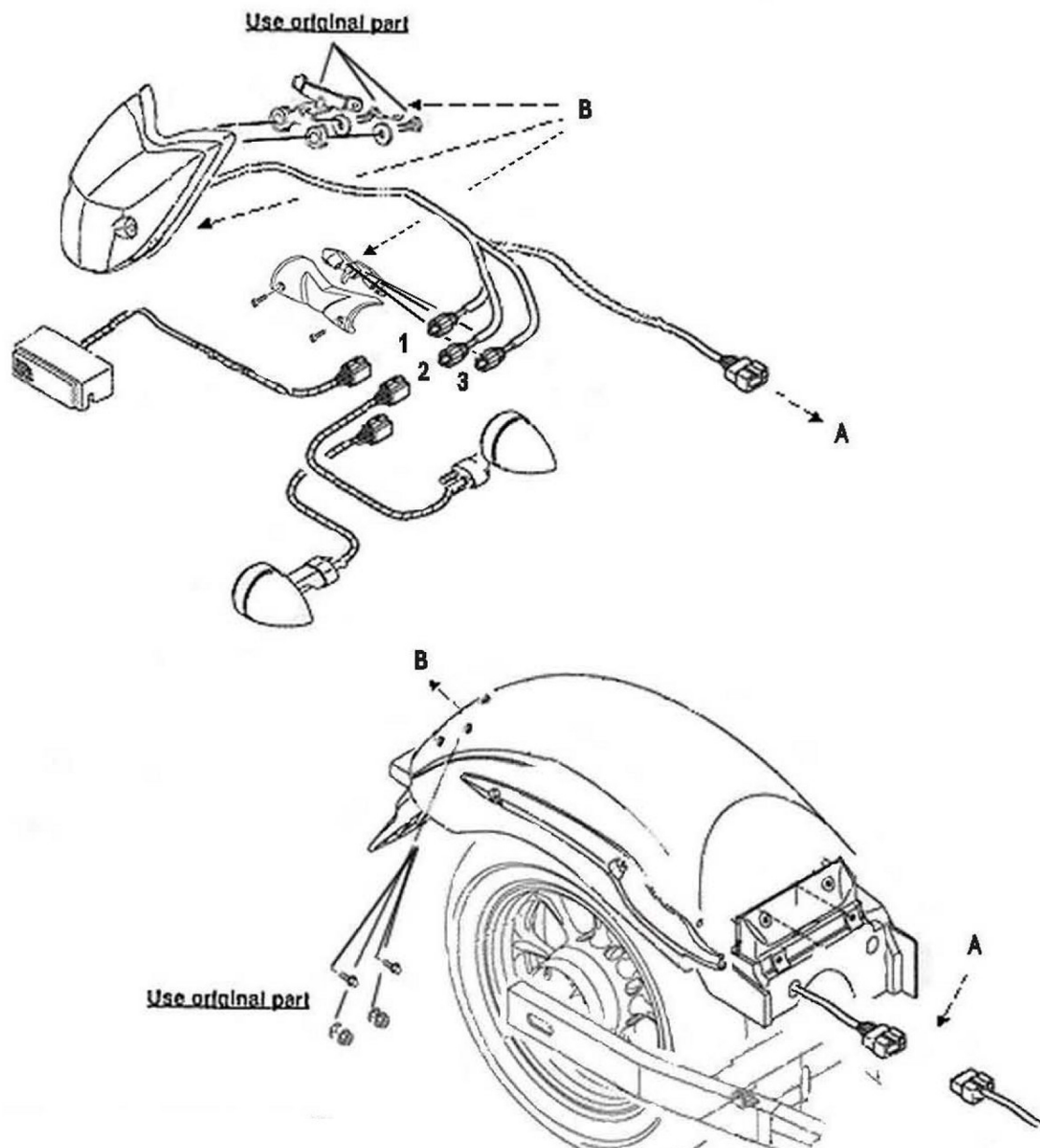

- 1) License plate light (Blue / Black)
- 2) Turnsignal Left (Brown / Black)
- 2) Turnsignal Right (Green / Black)

© Motorrad Burchard GmbH advises installation by a professional mechanic.  
We do not accept responsibility for improper installation.

© Motorrad Burchard GmbH  
Lemgo – Germany